



# Secure By Design Kit

## Installation Instructions

The Secured By Design Kit is fitted to Timber Sash Windows. Please read the instructions carefully before installation.

### Parts List

2 x Heritage Fitch Retainers	2 x Mighton Securibead™	2 x Cill Security Lock bolts
2 x Heritage Fitch Fasteners	1 x Meeting Rail Security Plate	1 x Cill Security Bar
4 x Locking Ventlocks	2 x Meeting Rail Security End Plates	1 x Cill Security Bar Shield
4 x Ventlock Key	2 x Cill Security Locks	

### Heritage Fitch Fastener and Ventlock Installation

1

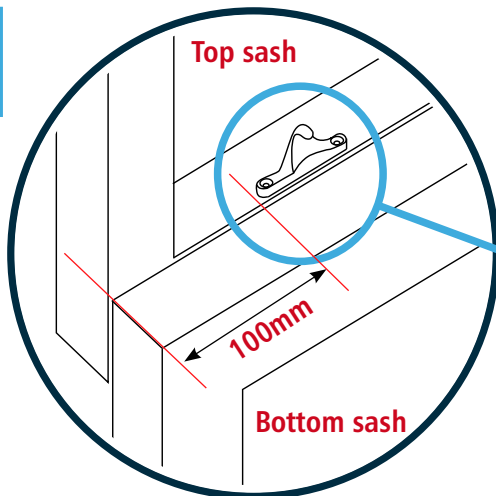

Install the Heritage Fitch Retainer onto the top sash 100mm in from the window frame.

Repeat process on opposite side.

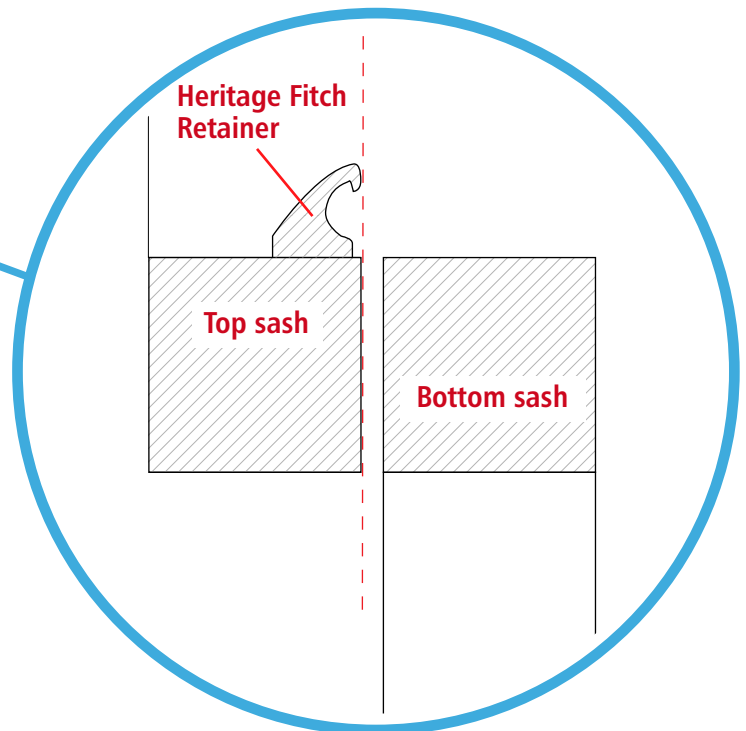

#### Important!

Align the complete Retainer with the front edge of the top sash, so none of the Retainer is extruding.



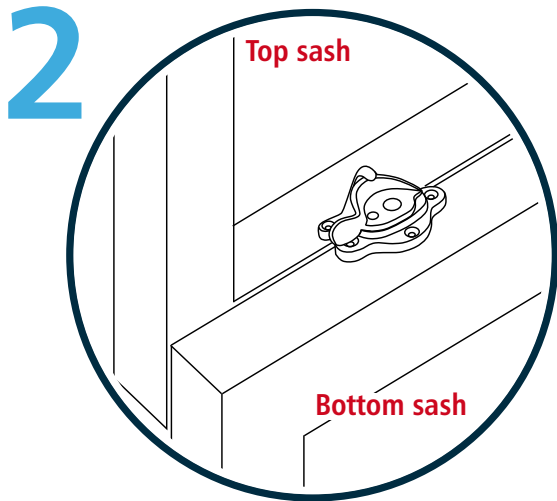

Position the Heritage Fitch Fasteners to fit the Retainer and install onto the bottom sash.

Repeat process on opposite side.

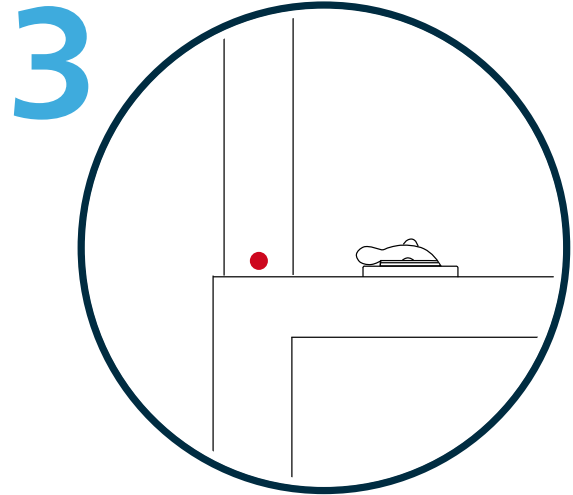

Position the bottom Ventlock so it almost touches the bottom sash when the window is closed. Mark and drill a 14mm diameter hole 30mm deep into the top sash.

Repeat process on opposite side.

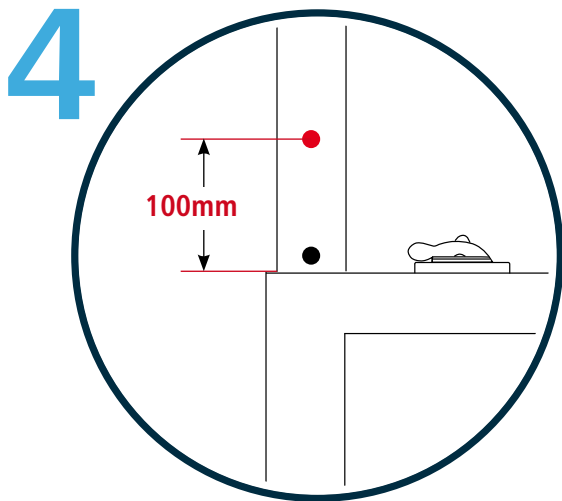

Measure 100mm up from top of bottom sash, mark and drill a 14mm diameter hole 30mm deep into the top sash.

Repeat process on opposite side.

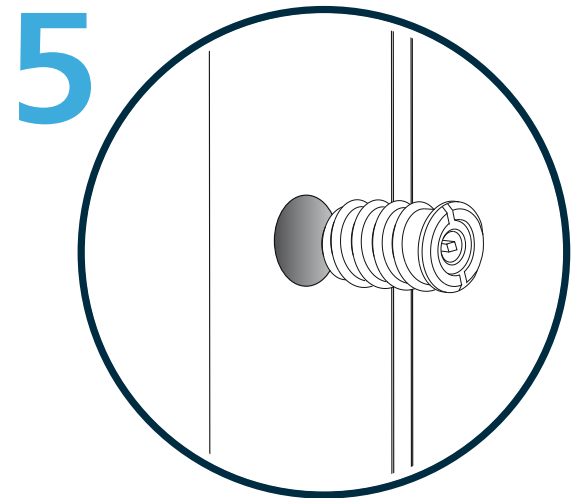

De-activate the Locking Ventlocks using the Key provided and install into the holes using a large flat bladed screwdriver or one of our insertion tools, part code: **VTOOLHAND** or **VTOOLDRILL**.

# Securibead Installation

1

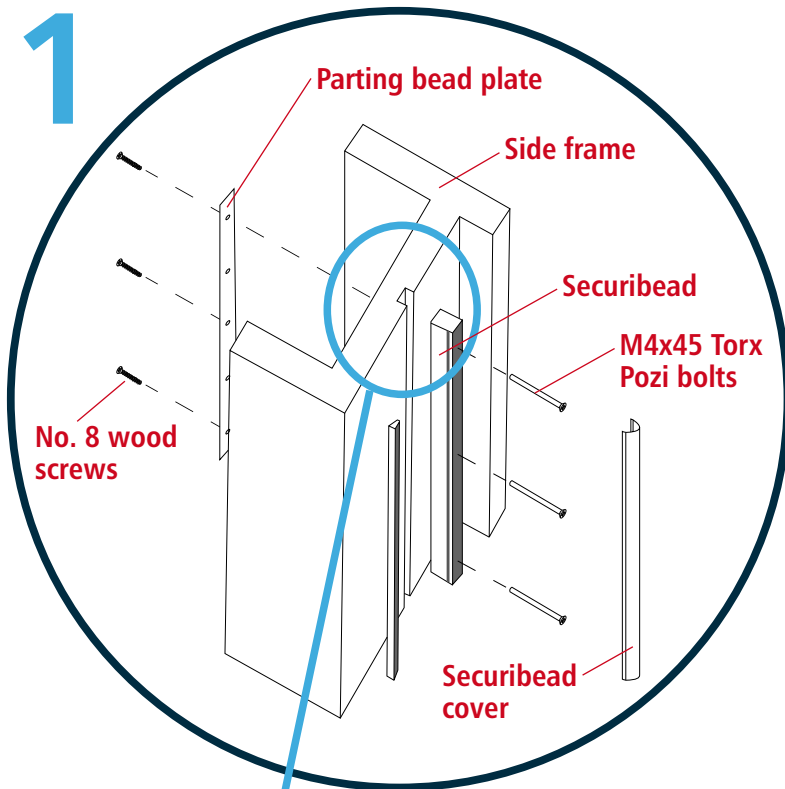

Cut a 12mm diameter, 8mm deep channel in the side frame.

Cut the Securibead to length and install into the channel, drilling clearance holes along the length at 80mm centres for the M4x45 Torx Pozi bolts.

Cut and secure the Parting Bead Plate onto the inside of the side frame using No. 8 wood screws.

Fit the Brush Strip and Securibead Cover.

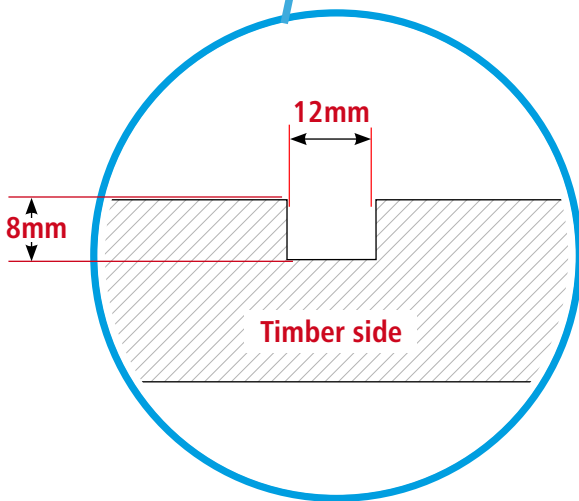

12mm diameter, 8mm deep channel in side frame

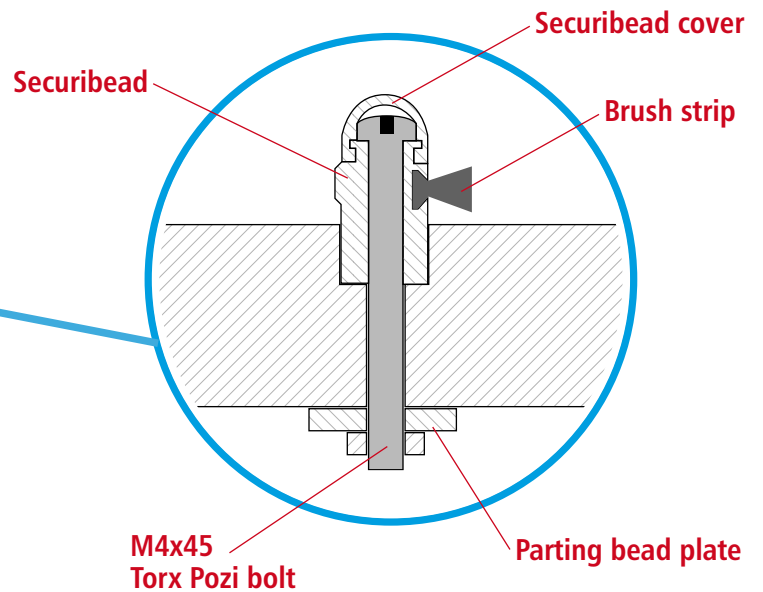

# Meeting Rail Security Plate and End Plates Installation

1

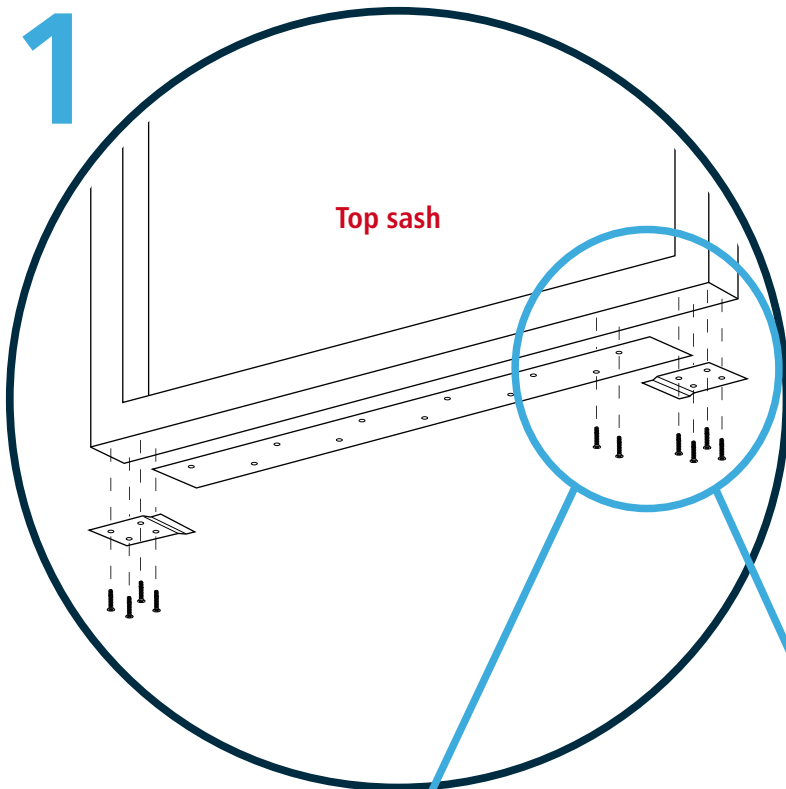

Install the End Plates and Meeting Security Rail onto the top sash. The Meeting Security Rail can be cut to the required size to fit between the End Plates.

**Important!**

Ensure the End Plates align with sides of top sash and the Meeting Security Rail is fitted so the front edge just clears the glass of the bottom sash, as shown below.

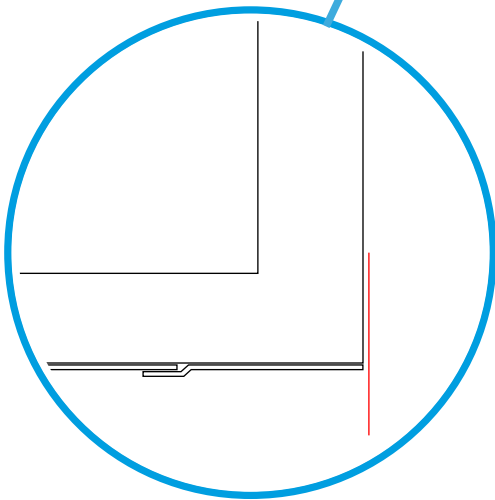

End Plates align with sides of top sash.

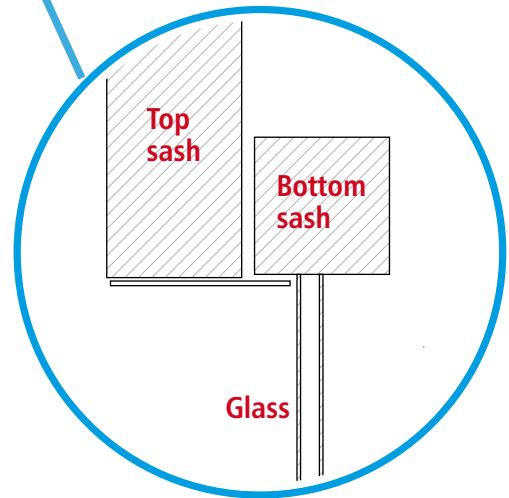

Fit the Meeting Security Rail so the front edge just clears the glass of the bottom sash.

## Cill Security Locks and Bolts Installation

1

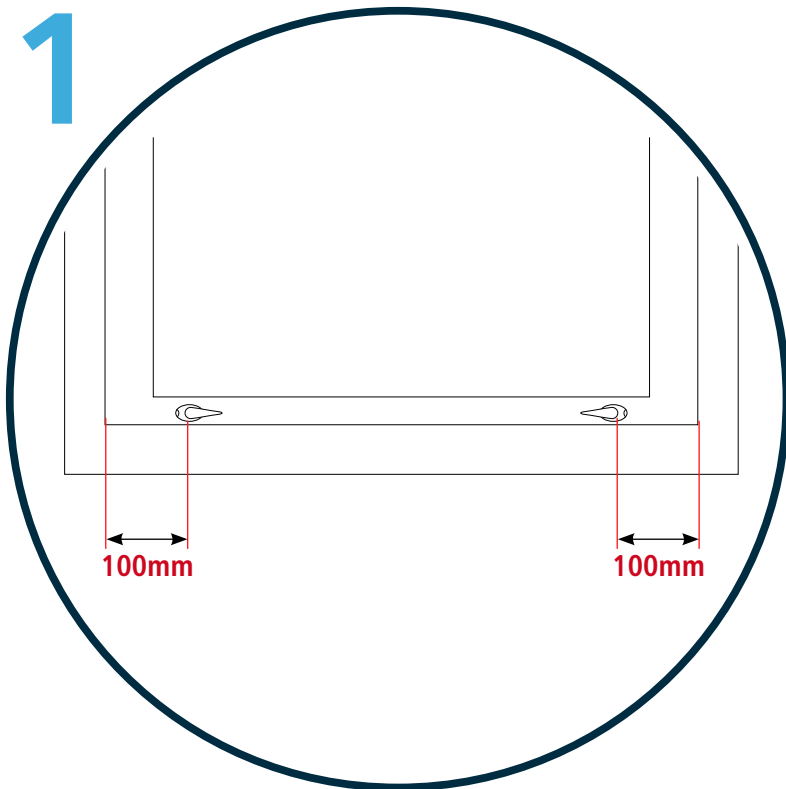

Position the Cill Locks so when the Sash is fully closed the escutcheon plate clears the top edge of the beading. Mark the position to be drilled.

Use left and right hand Cill Locks, so the handles face towards or away from each other when locking and unlocking.

4

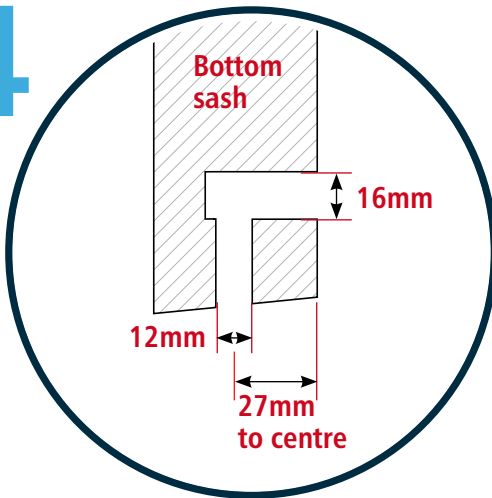

On the marked position, drill a horizontal 16mm diameter hole, 36mm (minimum) deep into the bottom sash.

Measure and mark the bottom sash 27mm back from the front edge of the bottom sash.

Drill a vertical 12mm diameter hole to meet the Cill Lock hole, as shown above.

Repeat process on opposite side.

5

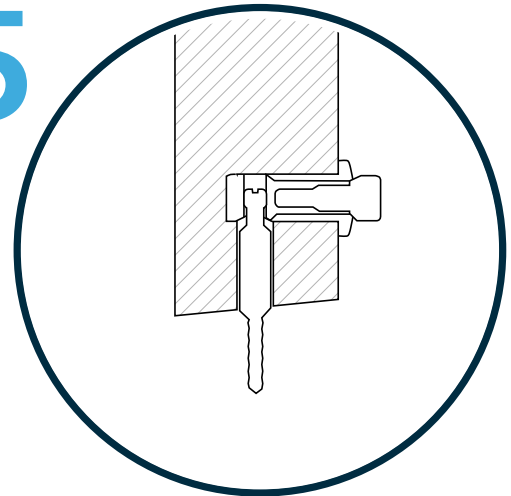

Install the Cill Locks into the bottom sash. Insert and lock the Cill Lock Bolts into the bottom of the sash.

Lower the sash and mark the positions to drill suitable pilot holes for the Cill Lock Bolts.

Raise the sash, drill pilot holes into the cill and install Cill Lock Bolts. Adjusting the height on the bolts as necessary to ensure a smooth locking action.

## Cill Security Bar and Shield Installation

1

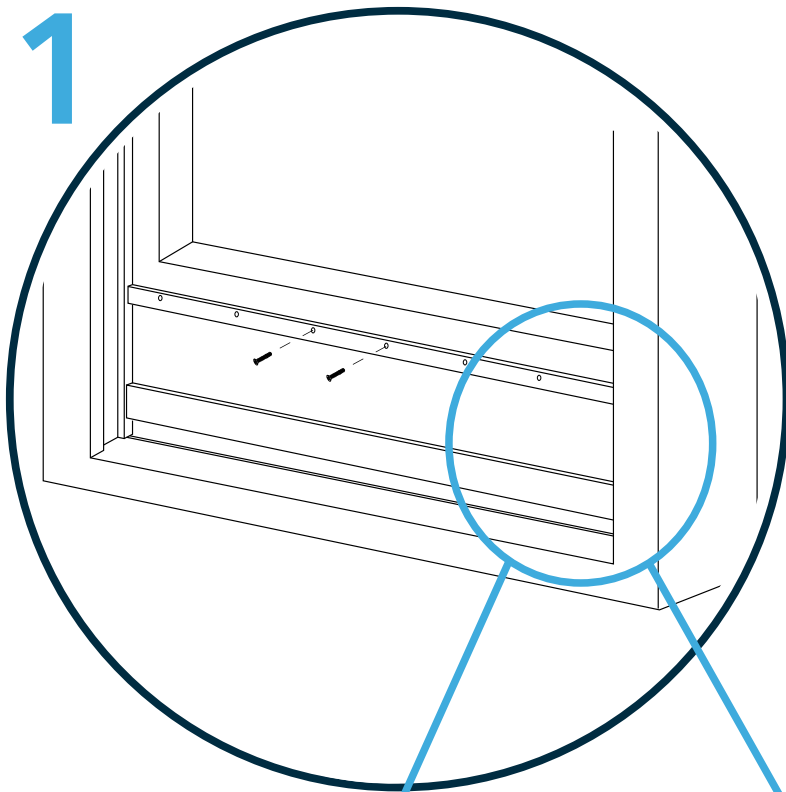

Cut the Cill Bar Shield to length so that the screw holes are even and centralised.

Obtain the correct position for the Cill Bar Shield by closing and locking the sash. Position and install the Cill Bar Shield on the bottom sash so the Cill Bar Shield front edge is just touching the cill.

Cut a 21mm diameter slot in cill for the length of the Cill Bar. Cut Cill Bar to length and fit into the slot using a suitable glue. Leave a 2mm gap at each end between the bar and frame, so as not to trap water behind the bar.

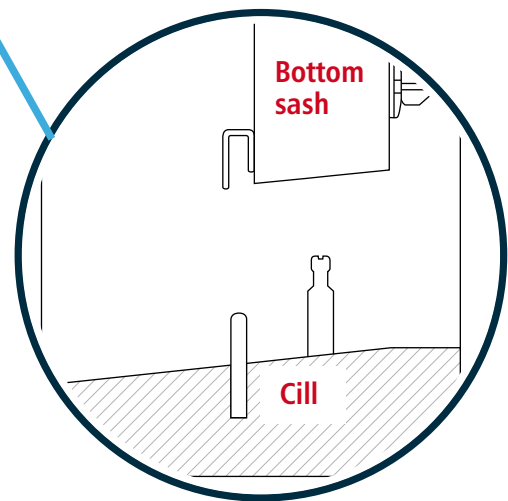
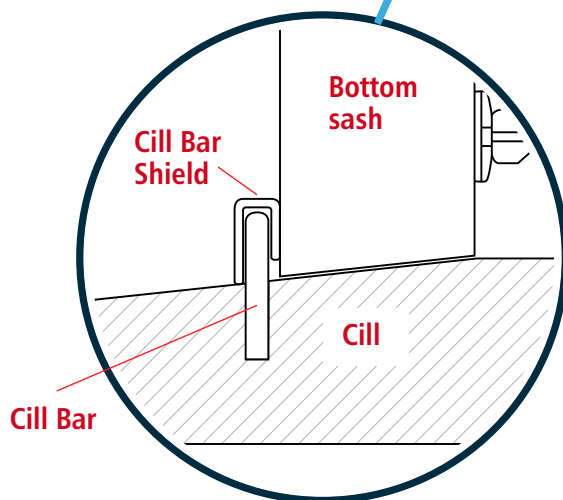

On the marked position, drill a horizontal 16mm diameter hole, 36mm (minimum) deep into the bottom sash.

Measure and mark the bottom sash 27mm back from the front edge of the bottom sash.

Drill a vertical 12mm diameter hole to meet the Cill Lock hole, as shown above.

Repeat process on opposite side.